



50 Hz

60 Hz



Stellar Pump
SCH Series



Horizontal Split Case Centrifugal Pump
Double Suction

Product Brochure

Commercial Water * Industrial Water * Air-Conditioning Water * Municipality Water



SCH Series

Horizontal Split Case Centrifugal Pump

Product Features

STELLAR SCH Series Horizontal split case centrifugal pumps are designed with double suctions. The said series have high flow capacities, high efficiency, cost economical, high quality & wide series of applications in commercial establishments, industrial sectors, municipal & water districts, irrigations and air-conditioning systems.

Advantages & Benefits

- **Axially split** top casing which allows easy removal of rotating assembly without disturbing the piping connections and driver (electric motor or diesel engine)
- **Built-in suction & discharge flange connections** in accordance to DIN 2501 PN16 GB
- **Heavy duty** cast iron pump volute casing suitable for working pressure of 16 bar. Working pressure of 25 bar is available on request.
- **Replaceable** wear rings to ensure optimum pump efficiency.
- Shaft seal is available in **Packing Gland** or **Mechanical Seal** in all types of applications.
- **Double Suction** designed impellers providing zero axial forces & dynamically balance during operation.

Model Identification

Example: **SCH 65 x 50 / 242 - 242**

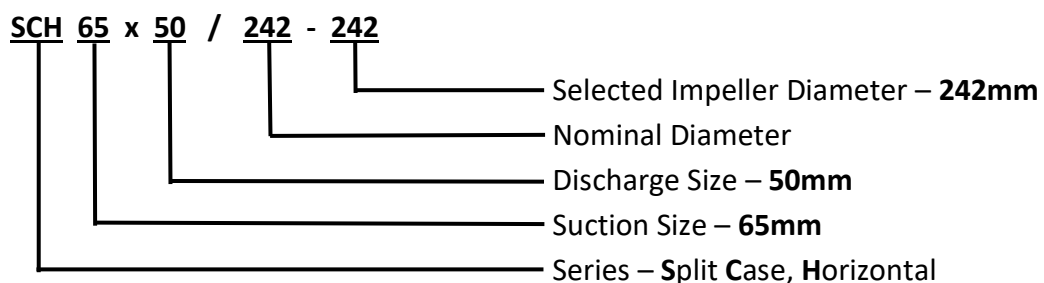

Exploded Drawing

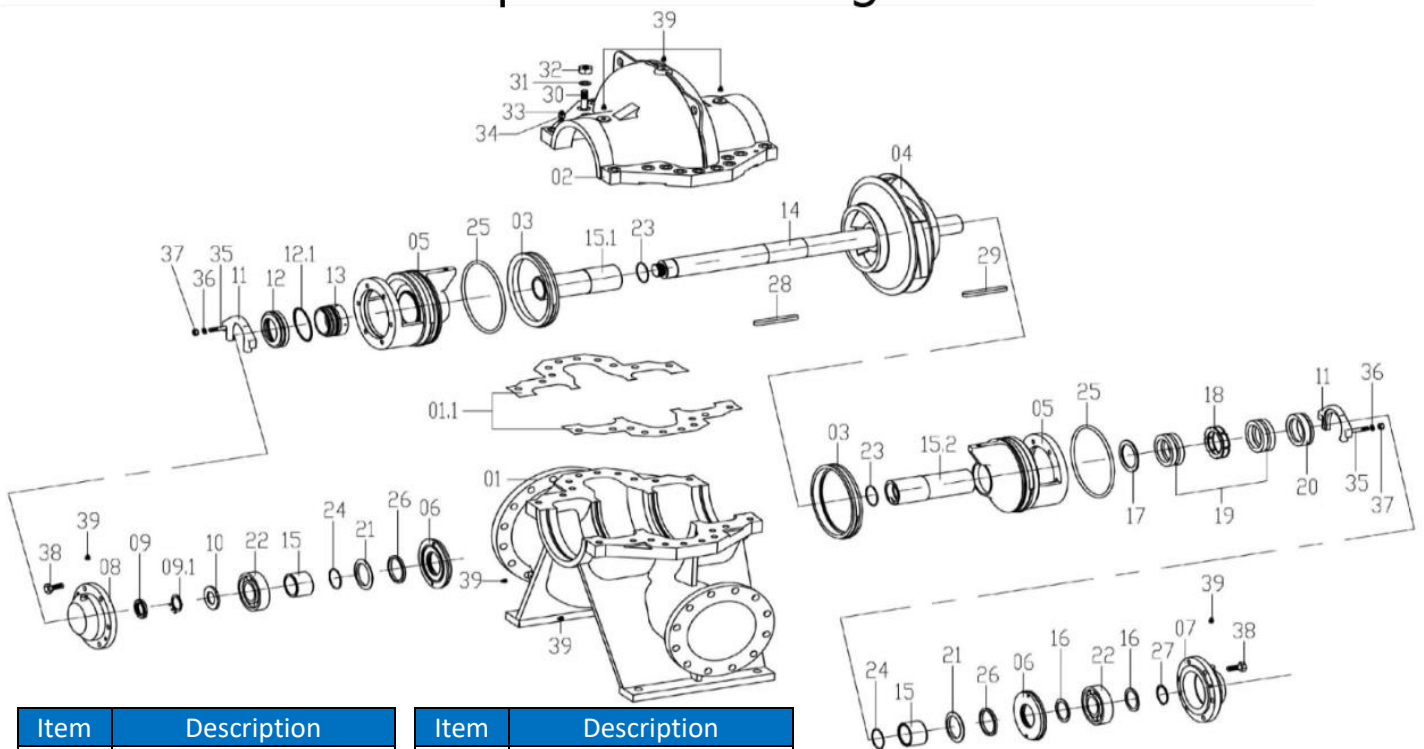

Item	Description	Item	Description
1	Bottom Casing	13	Mechanical Seal
1.1	Casing Gasket	14	Shaft
2	Top Casing	15	Shaft Sleeve – Short
3	Wear Ring	15.1	Shaft Sleeve
4	Impeller	15.2	Packing shaft Sleeve
5	Seal Frame	16	Bearing Seal Plate
6	Bearing Cover	17	Packing Seal Plate
7	Bearing Frame – Driver Side	18	Lantern Ring
8	Bearing Frame – Non Driving Side	19	Gland
9	Screw Nut	20	Packing Cover
9.1	Lock Washer for Nut	21	Slinger
10	Bearing Slinger	22	Ball Bearing
11	Seal Plate	23	O-Ring
12	Seal Cover	24	
12.1	Seal Cover Gasket	25	
		26	Felting
		27	External Circlips

Item	Description
28, 29	Key
30	Screw Bolt
31	Spring Washer
32	Screw Nut
33	Pin
34	Screw Nut
35	Screw Bolt
36	Flat Gasket
37	Screw Nut
38	Screw Bolt
39	Plug

Major Parts Material

PUMP PARTS	STANDARD	OPTION ON REQUEST
Pump Volute	Cast Iron	Ductile Iron
Impeller	Bronze	Cast Iron, ASTM304 & ASTM316
Pump Shaft	Steel ASTM1045	ASTM304, ASTM316 & ASTM420
Shaft Seal	Mechanical Seal	Packing Gland

Technical Information

Pump Capacity Ranges (Q)	36 m ³ /hr to 3,400 m ³ /hr
Pump Head Ranges (H)	8 meters to 190 meters
Speed	50Hz 2900 rpm (2 pole) or 1450rpm (4 pole) 60Hz 3500rpm (2 pole) or 1750rpm (4 pole)
Working Temperature Ranges	-10 deg. Celsius to 90 deg. Celsius
Max Working Pressure	16 Bar, 25 Bar on request
Fluid Medium	Non aggressive, clean water or liquids similar to physical properties of clean water

Applications

- **Clean Water Supply**
 - Transfer of water supply
 - Pressure booster for commercial establishments, high rise buildings, hotels, etc.
 - Pressure booster for industrial structures, factories, etc.
- **Air Conditioning Systems**
 - Chilled & condenser water supply
 - Cooling tower make up water
- **Irrigation & Agriculture**
 - Field & crops irrigation
 - Aqua farming
- **Municipal**
 - Water distribution in districts & municipality
 - Pressure booster
- **Fire Fighting Systems**
 - Automatic fire sprinkler systems
 - Fire hose cabinets & hydrants